

# Teilbibliothek 2 – Branch Library 2

## Erdgeschoss – Ground Floor

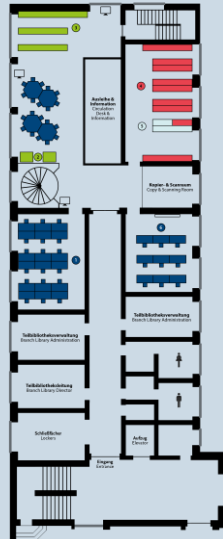

## Untergeschoss – Basement

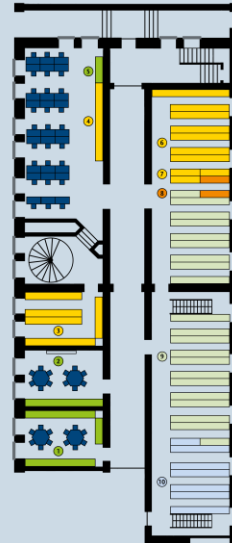

## Kellergeschoss – Lower Basement

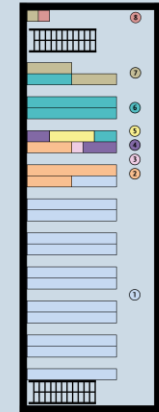

- Stiller Lesesaal **1** Quiet Reading Room
- Selbstverbucher **2** Self-Service Checkout
- Selbstabholregale **3** Pick-Up Shelves
- Schulbuchsammlung **4** School Textbook Collection
- Semesterapparate **5** Course Reserves
- Schulungsraum mit PCs **6** Training Room with PCs
- Auskunfts-PC Information PC

- Gruppenraum, Zeitschriftenbände **1** Group Room, Periodicals
- Gruppenraum (buchbar), Zeitschriftenbände **2** Group Room (bookable), Periodicals
- Lehrbuchsammlung Psychologie (23/CL-CU) **3** Textbook Collection Psychology (23/CL-CU)
- Lehrbuchsammlung Psychologie (23/CW-CY) **4** Textbook Collection Psychology (23/CW-CY)
- Zeitschriftenhefte **5** Periodicals (Current Volumes)
- Lehrbuchsammlung Pädagogik (23/DA-DU) **6** Textbook Collection Educational Science (23/DA-DU)
- Lehrbuchsammlung Didaktik der Naturwiss. (23/S-Z) **7** Textbook Collection Didactic Natural Sciences (23/S-Z)
- Loseblattsammlungen **8** Loose-Leaf Collection
- Psychologie (21, 25/C) **9** Psychology (21, 25/C)
- Pädagogik (21,25/DA-DK) **10** Educational Science (21,25/DA-DK)

- Pädagogik (21, 25/DL-DW) **1** Educational Science (21, 25/DL-DW)
- Mathematik (21, 25/S) **2** Mathematics (21, 25/S)
- Naturwissenschaften (21, 25/T) **3** Natural Sciences (21, 25/T)
- Physik (21, 25/U) **4** Physics (21, 25/U)
- Chemie, Pharmazie (21, 25/U, V) **5** Chemistry, Pharmacy (21, 25/U, V)
- Biologie (21, 25/W) **6** Biology (21, 25/W)
- Medizin (21, 25/X, Y) **7** Medicine (21, 25/X, Y)
- Land- & Forstwirtschaft, Gartenbau, Technik (21, 25/Z) **8** Agriculture, Forestry, Horticulture, Engineering (21, 25/Z)